

September BOM

Louisiana—*Around the Block with Judy Hopkins* page 83

I have blueberries on my mind, so this pinwheel block features blueberry fabric pinwheels with an off white/cream background and one coordinating fabric.

This block should measure 8 1/2" when you are finished

I have included two instructions for creating flying geese.

Cutting instructions:

Background fabric—off white/cream
4 2 1/2" x 4 1/2" rectangle

Flying Geese:

Blueberry fabric
4 2 1/2" x 4 1/2" rectangles
Coordinating fabric
8 2 1/2" x 2 1/2" squares

OR

No Waste Flying Geese:

Blueberry fabric
1 5 1/4" square
Coordinating fabric
4 2 7/8" x 2 7/8" squares

Sewing instructions:

Flying Geese—draw diagonal lines on the wrong side of the 8 2 1/2" squares. With right sides together sew as shown in diagrams.

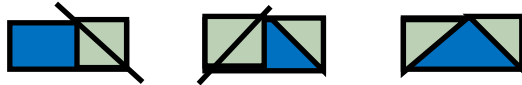

No Waste Flying Geese—draw diagonal lines on the wrong side of the 4 2 1/2" squares. Follow the pictures below. You can also go to <https://www.thesprucecrafts.com/no-waste-flying-geese-for-quilts-2821760>

(right click and then Open Hyperlink)

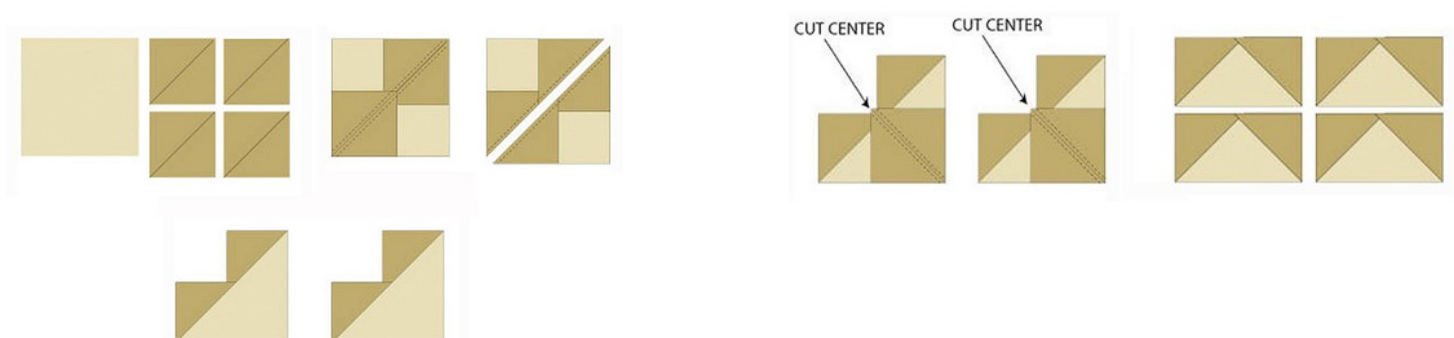

Follow pictures to construct block:

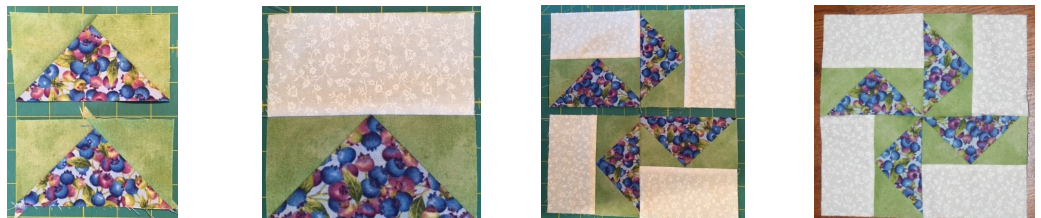

Trim Flying Geese to 2 1/2" x 4 1/2" which will also trim off dog ears.